



# AUSTRALIA WIDE FIRE SUPPLIES

ABN 80 393 915 621

PO Box 25

Cardiff NSW 2285

Unit 5/54 Pendlebury Rd

Cardiff NSW 2285

Phone. (+61) 02 4954 0333

Fax. (+61) 02 4956 6195

Email. sales@awfs.com.au

Website. www.awfs.com.au

## TFMAS ROLL & FOAM MOBILE FOAM ATTACK SYSTEM

The TFMAS, "Roll & Foam", Mobile Foam Attack System is a self-contained unit that can transform any pressurized fire hose, water supply line or stand pipe into a fire fighting foam generating station. An average person can roll the unit to a pressurized water source near a fire scene even when the tank is filled to capacity with fire fighting foam concentrate (foam concentrate not included). By following the instructions on the top of the tank, the user can deploy, set-up and spray foam in under a minute.

The TFMAS Roll & Foam can be installed in an accessible area and quickly deployed in case of an emergency. The unit can be used in industrial sites, installations, warehouses and storage facilities, schools, shopping centres or even marinas, harbours or aircraft hangers (Class B foam units recommended).

The system consists of a wheeled supply tank with a 14 gallon capacity, a 15 meter length of lay-flat hose, a 30gpm eductor factory set for either 1% for Class A foam or 3 % for Class B foam, a matching Air Aspirating Foam Nozzle and D-Handle, Pistol Grip Shut-off with swivel connector. The educator is designed for a nominal operating pressure of between 50 and 100psi. The supply tank must be filled with foam concentrate prior to deployment. The threads on the swivel connector on the Eductor are the standard, 1-1/2", BSP thread type. The user must confirm thread type compatibility between the unit and the water supply prior to installation. A Thread Adaptor may be necessary.



The eductor, pistol grip shut-off and base of the nozzle are made from glass-reinforced engineering grade nylon, making it extremely durable and resistant to corrosion. The barrel of the nozzle is made from high-impact ABS polymer.

Unit Weight: 22LBS (Empty)

Unit Dimensions: 860mm H x 480mm W x 385mm D

A fabric dust cover is available for the unit, stock code TFMASDC

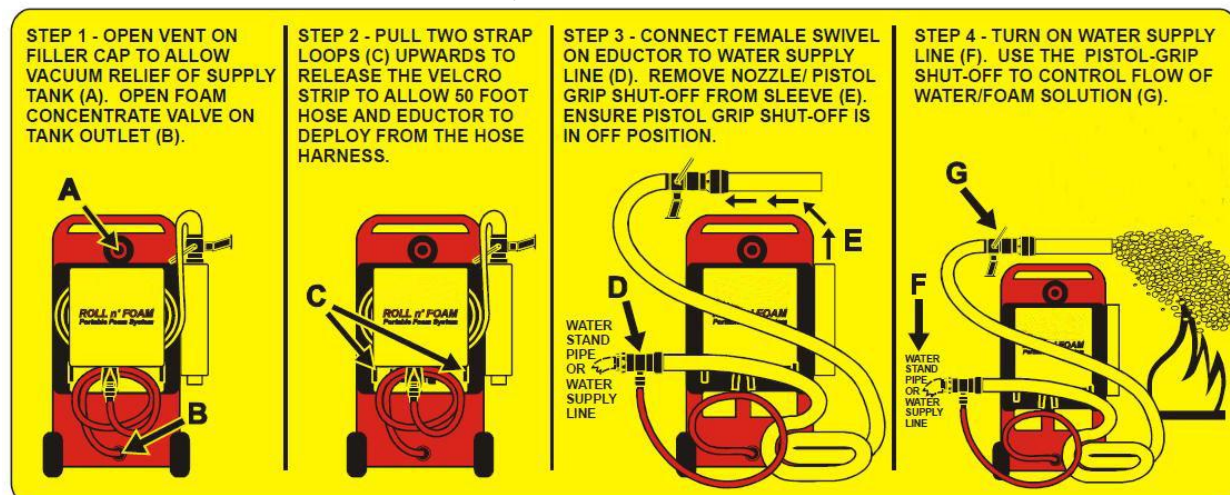



## TFMAS ROLL & FOAM MOBILE FOAM ATTACK SYSTEM INSTRUCTIONS FOR INSTALLATION

*\*IMPORTANT – Read these instruction thoroughly PRIOR to installation.*

- A. This TFMAS unit is calibrated for use with Class A foam at an education rate of 1%. This unit DOES NOT come pre-filled with foam concentrate. The tank must be filled with Class A Foam Concentrate prior to installation.
- B. Compatibility of the hose thread must be confirmed prior to installation. The TFMAS comes with BSP (Pipe) threads on the input side (female swivel) of the eductor. Most standpipes and fire cabinet hose are BSP Compatible. Before installing the unit check the thread type on the standpipe or hose lines that could be the water source for the unit. If NHT threads are required, a thread changer adaptor must be obtained and installed on the input side (female swivel) of the eductor.
- C. It is recommended that the above steps are taken and the unit is tested on site prior to installation. This is a good opportunity to train designated person(s) who may be required to deploy the unit.
- D. Read the deployed instructions on top of the tank carefully and thoroughly (copy below). It is very important that STEP 1 of the instructions be completed properly. If the vacuum relief and concentrate valves are not opened, the unit will not create foam. These valves must be opened before the flow of water is turned on.
- E. If the unit is deployed for testing or training, the hose must be rolled back up in a “centre roll” style. Disconnect the hose form the Eductor and the Pistol Grip Shut-Off. Fold the hose roughly in half with a male threaded end extending 1mt past the female end. Begin rolling the hose at the folded end, roll up as tightly as possible. Lay the tank down with the harness facing up. Pull open the harness flap and lay the hose bundle in place. Insert Pistol Grip Shut-Off/Nozzle into sleeve. Connect the hose ends to the Eductor and the Pistol Grip Shut-Off. Hold the Eductor in place against the bottom of the hose bundle and pull harness flap over hose and eductor. There are two short lengths of webbing with Velcro that act as extra holders for the Eductor. Try to get the flap as tight as possible to hold the hose bundle in place until deployment is required.
- F. After following the above steps, the TFMAS Roll & Foam can be pre-positioned in an accessible area and quickly deployed when needed in an emergency.



STEP 1 - OPEN VENT ON FILLER CAP TO ALLOW VACUUM RELIEF OF SUPPLY TANK (A). OPEN FOAM CONCENTRATE VALVE ON TANK OUTLET (B).

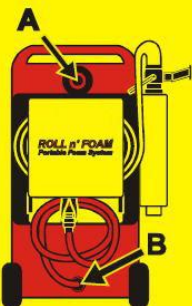

STEP 2 - PULL TWO STRAP LOOPS (C) UPWARDS TO RELEASE THE VELCRO STRIP TO ALLOW 60 FOOT HOSE AND EDUCTOR TO DEPLOY FROM THE HOSE HARNESS.

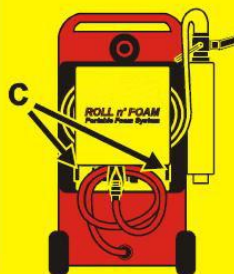

STEP 3 - CONNECT FEMALE SWIVEL ON EDUCTOR TO WATER SUPPLY LINE (D). REMOVE NOZZLE/ PISTOL GRIP SHUT-OFF FROM SLEEVE (E). ENSURE PISTOL GRIP SHUT-OFF IS IN OFF POSITION.

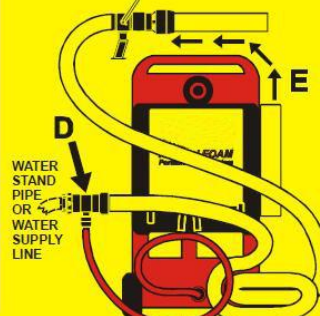

STEP 4 - TURN ON WATER SUPPLY LINE (F). USE THE PISTOL-GRIP SHUT-OFF TO CONTROL FLOW OF WATER/FOAM SOLUTION (G).

